

# TEMPLATE

BLACK IS CUT LINE

MAGENTA IS IMPRINT AREA

(Keep important graphics and text within this area)

CYAN IS BLEED

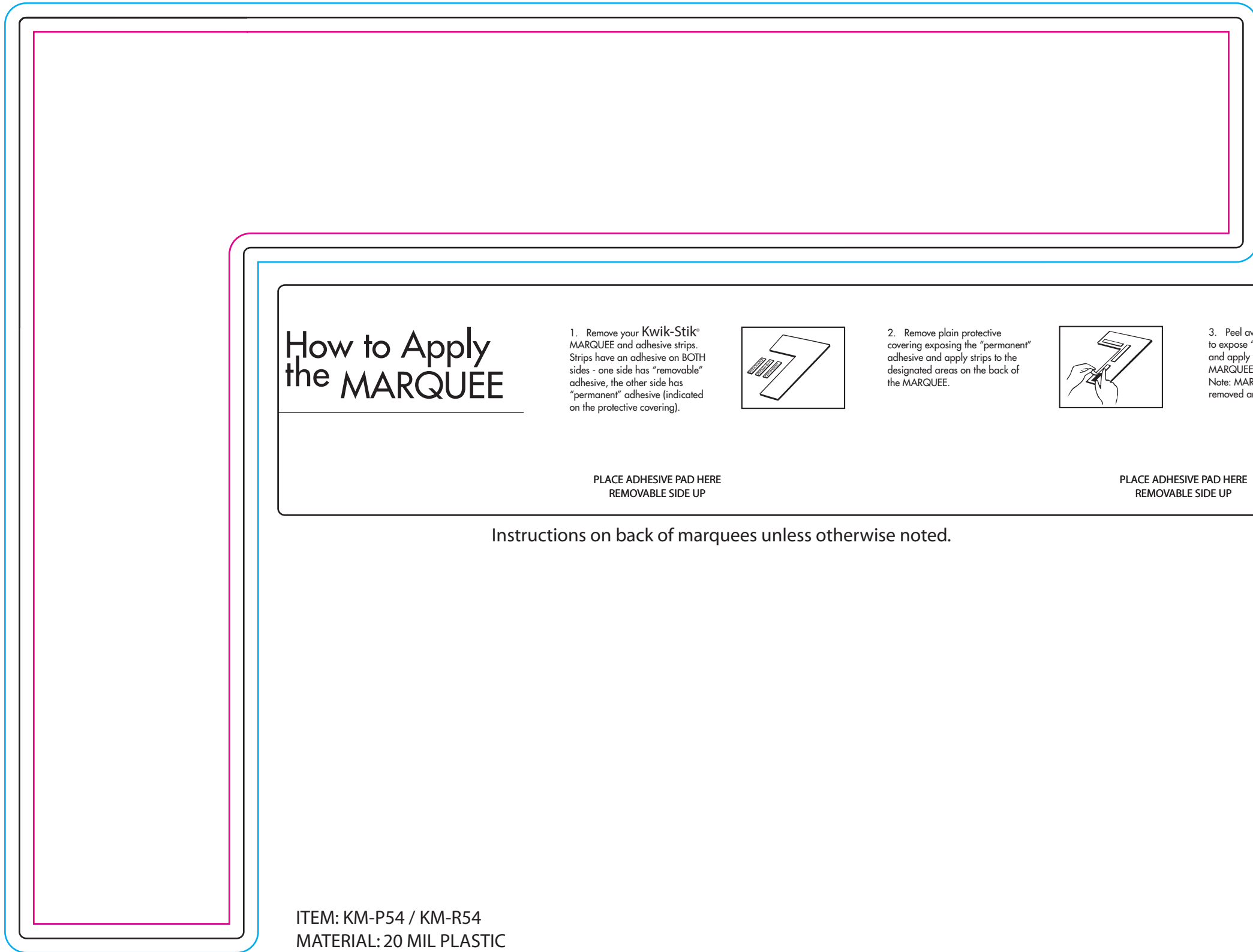

## How to Apply the MARQUEE

1. Remove your Kwik-Stik® MARQUEE and adhesive strips. Strips have an adhesive on BOTH sides - one side has "removable" adhesive, the other side has "permanent" adhesive (indicated on the protective covering).

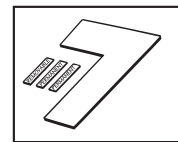

2. Remove plain protective covering exposing the "permanent" adhesive and apply strips to the designated areas on the back of the MARQUEE.

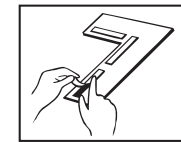

3. Peel away protective covering to expose "removable" adhesive and apply your Kwik-Stik® MARQUEE to the monitor frame. Note: MARQUEE can be easily removed and repositioned.

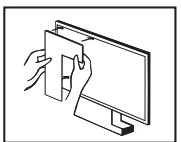

PLACE ADHESIVE PAD HERE  
REMOVABLE SIDE UP

PLACE ADHESIVE PAD HERE  
REMOVABLE SIDE UP

Instructions on back of marquees unless otherwise noted.

PLACE ADHESIVE PAD HERE  
REMOVABLE SIDE UP

ITEM: KM-P54 / KM-R54  
MATERIAL: 20 MIL PLASTIC  
SIZE: 10.625" X 8"  
IMPRINT COLORS:

Notes:

Colors viewed will vary vastly from monitor to monitor. Do NOT rely on screen images for exact color matches. A physical proof can be supplied for color critical applications. Two types of proof are available for color approval. Production proofs show exact color, contract proofs show approximate color. Contact printer for color proofing options and pricing pertaining to order.

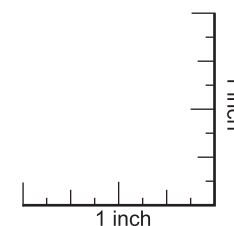

ITEM: KMRS4 FULL COLOR MARQUEE  
WWW.FINN-LINE.COM  
ASI 54290 SAGE 56210